

MAXIM COST EFFECTIVE LIGHTING SOLUTION

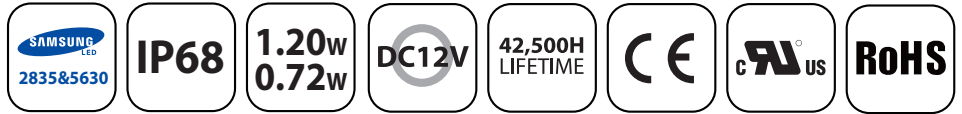

- Guaranteed life time up to 42,500 hours with 70% lighting output
*24 hour constant load may result less operating hours with lower lighting output. Estimated lifetime is based on normal usage of 10 hours per day.
- Outstanding IP rating by Ultra Sonic Welding Technology
- IP68 Rating-Prevents water & dust penetration
- PC + ABS body for tough environment

PHYSICAL

Length : 66.4mm
 Width : 15.4mm
 Thickness : 9.4mm
 Weight : 14g
 Module Pitch : 150mm
 Module spacing : 83mm(2pcs per ft)

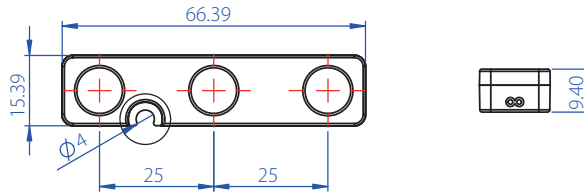

OPTICAL CHARACTERISTICS

Available Color	Luminous Flux(lm)			CCT (K) & Wave Length(nm)			Viewing Angle
	Min	Typical	Max	Min	Typical	Max	2Θ _{1/2}
Cool White		100		10,000K		12,000K	160
Daylight White		100		5,000K	5,700K	6,500K	160
Neutral White		100		3,500K		4,000K	160
Warm White		90		2,700K		3,000K	160
Red		15		620		630	160
Green		13.5		515		525	160
Blue		12		466		472	160

*CRI (Color Rendering Index) for white product types is 70 / *Luminous Flux measuring equipment is CAS140B
 *Viewing angle is the off axis angle from lamp centerline where the luminous intensity is half of the peak value / *CCT 5% tester tolerance
 *Dominant wavelength is derived from the CIE 1931 Chromaticity diagram and represents the perceived color
 *Color temperature for white is strictly controlled by bin rank system and it consists of three ranks which should not be used simultaneously.



ELECTRICAL CHARACTERISTICS

Current dissipation : 100mA/White, 60mA/colored
 Power Consumption : 1.2W/White, 0.72W/colored
 Operating power : DC 12V
 Quantity for maximum connection in serial : 50 modules
 Electronic dimming control supported

THERMAL

Cooling : Ambient air
 Operating temperature : -20~50°C
 Storage temperature : -20~60°C

SAFETY FEATURES

IP68 : Prevents water & dust penetration

CONSTRUCTION

LED Lamp : 2835 Package
 Body : PC + ABS
 Lead wire : 20AWG

APPLICATIONS

Channel letters - open & closed cover
 Reverse halo lighting
 Border lighting
 Point-Of-Purchasing signage
 Art & sculpture and cove lighting
 Facade lighting

APPROVAL

EN 55015/A2 : 2009
 EN 61547/2009
 EN 62031/2008 +A1 : 2013 +A2 : 2015
 EN 62471/2006
 UL879-U.S Standard for Electric Sign Components
 C22.2 No. 207-M89-Canadian Standard for Portable and Stationary Electric Signs and Displays

WIRING GUIDE

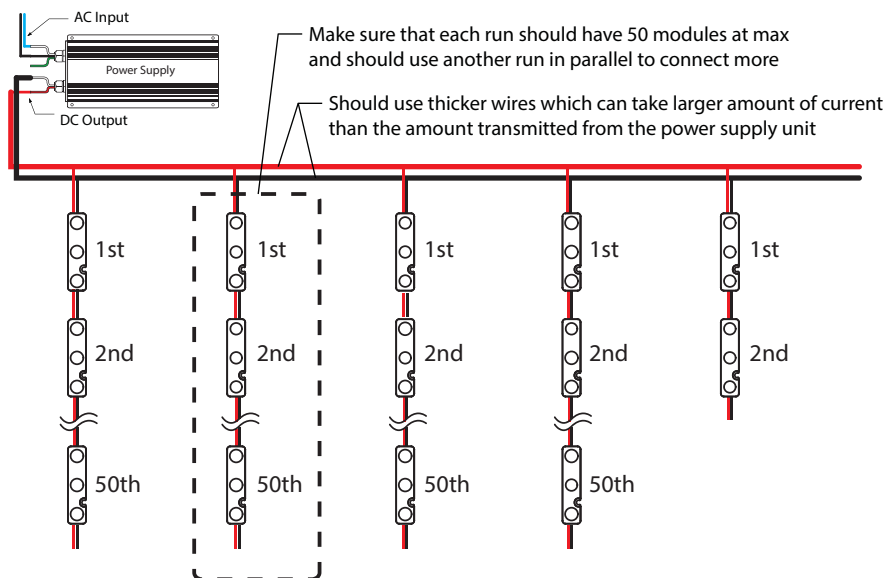

PACKAGING

Anti-static transparent vinyl bag : 100modules(15.00meter, 49ft)
 Master carton box : 1000modules(150.00meter, 490ft)

Specifications subject to change without notice