

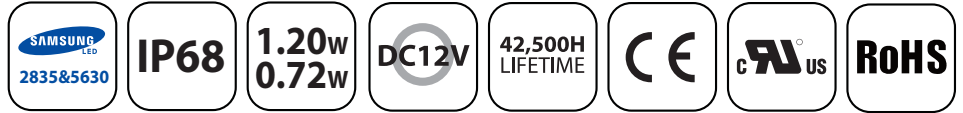

MAXIM COST EFFECTIVE LIGHTING SOLUTION



- Guaranteed life time up to 42,500 hours with 70% lighting output
*24 hour constant load may result less operating hours with lower lighting output. Estimated lifetime is based on normal usage of 10 hours per day.
- Outstanding IP rating by Ultra Sonic Welding Technology
- IP68 Rating-Prevents water & dust penetration
- PC + ABS body for tough environment

PHYSICAL

Length : 66.4mm
 Width : 15.4mm
 Thickness : 9.4mm
 Weight : 14g
 Module Pitch : 150mm
 Module spacing : 83mm(2pcs per ft)

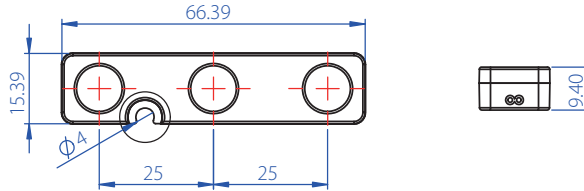

OPTICAL CHARACTERISTICS

Available Color	Luminous Flux(lm)			CCT (K) & Wave Length(nm)			Viewing Angle 2θ _{1/2}
	Min	Typical	Max	Min	Typical	Max	
Cool White		120		10,000K		12,000K	135
Daylight White		120		5,000K	5,700K	6,500K	135
Neutral White		120		3,500K		4,000K	135
Warm White		110		2,700K		3,000K	135
Red		15		620		630	135
Green		13.5		515		525	135
Blue		12		466		472	135

*CRI (Color Rendering Index) for white product types is 70 / *Luminous Flux measuring equipment is CAS140B
 *Viewing angle is the off axis angle from lamp centerline where the luminous intensity is half of the peak value / *CCT 5% tester tolerance
 *Dominant wavelength is derived from the CIE 1931 Chromaticity diagram and represents the perceived color
 *Color temperature for white is strictly controlled by bin rank system and it consists of three ranks which should not be used simultaneously.

Specifications

STAR F0325L 135

ELECTRICAL CHARACTERISTICS

Current dissipation : 100mA/White, 60mA/colored
Power Consumption : 1.2W/White, 0.72W/colored
Operating power : DC 12V
Quantity for maximum connection in serial : 50 modules
Electronic dimming control supported

THERMAL

Cooling : Ambient air
Operating temperature : -20~50°C
Storage temperature : -20~60°C

SAFETY FEATURES

IP68 : Prevents water & dust penetration

CONSTRUCTION

LED Lamp : 2835 Package
Body : PC + ABS
Lead wire : 20AWG

APPLICATIONS

Channel letters - open & closed cover
Reverse halo lighting
Border lighting
Point-Of-Purchasing signage
Art & sculpture and cove lighting
Facade lighting

APPROVAL

EN 55015/A2 : 2009
EN 61547/2009
EN 62031/2008 +A1 : 2013 +A2 : 2015
EN 62471/2006
UL879-U.S Standard for Electric Sign Components
C22.2 No. 207-M89-Canadian Standard for Portable and Stationary Electric Signs and Displays

WIRING GUIDE

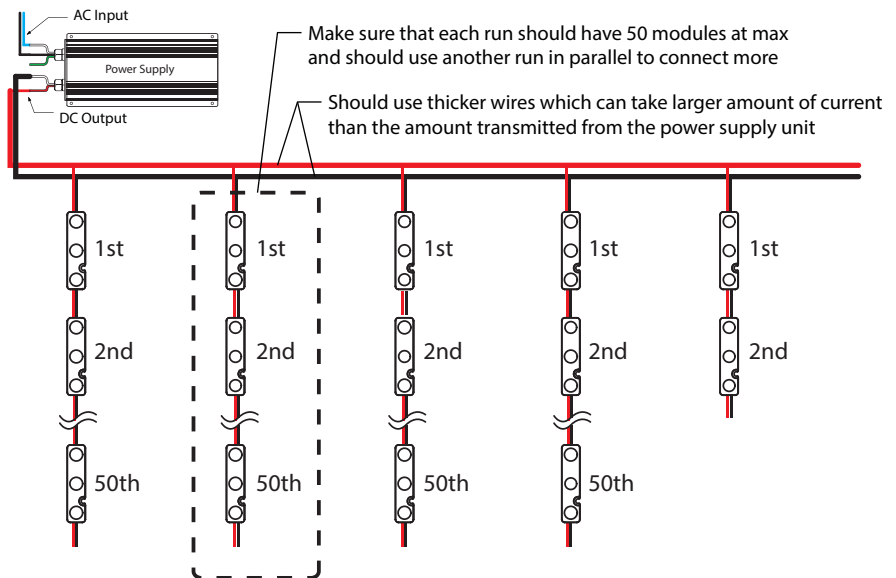

PACKAGING

Anti-static transparent vinyl bag : 100modules(15.00meter, 49ft)
Master carton box : 1000modules(150.00meter, 490ft)

Specifications subject to change without notice